

# FUTEK MODEL L2706

# LOAD WASHER LOAD CELL

Drawing Number: F1426-03

INCH [mm] | R.O.= Rated Output

## WIRING CODE

+Excitation	-Excitation	+Signal	-Signal
RED	BLACK	GREEN	WHITE

4X #10-32-2B X 0.31 DEEP  
EQUALLY SPACED ON  
0.84 B.C.D.

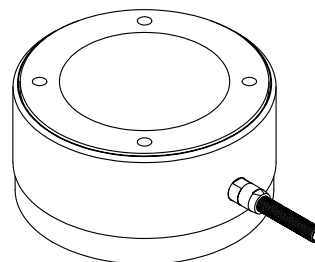
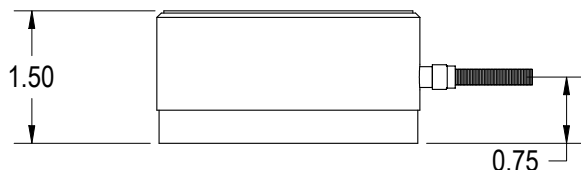
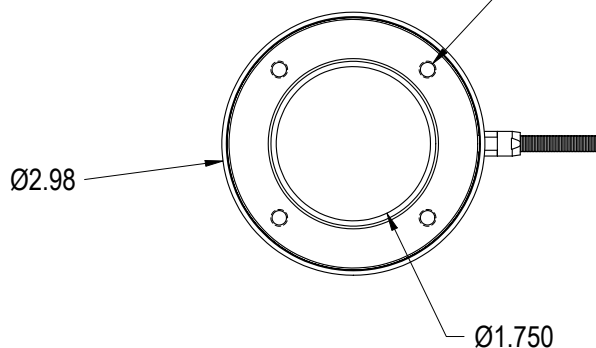

## SPECIFICATIONS:

**RATED OUTPUT**

0.8 mV/V nominal (FATIGUE RATED)

**CAPACITY** lb  
Kg

2000  
907

**SAFE OVERLOAD**

150% of R.O.

**ZERO BALANCE**

±3% of R.O.

**EXCITATION (VDC OR VAC)**

18 VDC MAX

**BRIDGE RESISTANCE**

500/700  $\Omega$  nom.

**NONLINEARITY**

±1% of R.O.

**HYSTERESIS**

±1% of R.O.

**NONREPEATABILITY**

±0.2% of R.O.

**TEMP. SHIFT ZERO**

0.005% of LOAD/°F (0.009% of R.O./°C)

**TEMP. SHIFT SPAN**

0.005% of LOAD/°F (0.009% of R.O./°C)

**COMPENSATED TEMP.**

60 to 160°F (15 to 82°C)

**OPERATING TEMP.**

-60 to 212°F (-50 to 100°C)

**WEIGHT**

7 oz [198 g]

**MATERIAL**

ANODIZED ALUMINUM

**CABLE: #26 AWG, 4 Conductor, Braided Shielded Teflon Cable 5 ft [ 1.5 m ] Long**

**ACCESSORIES AND RELATED INSTRUMENTS AVAILABLE**

**CALIBRATION (STD)**

5 pt. COMPRESSION; 100 K $\Omega$  SHUNT CAL. VALUE

**CALIBRATION TEST EXCITATION**

10 VDC